

# TECHNICAL DATA

## G.A. DRAWING :

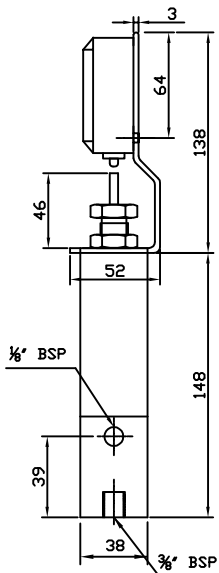

Pressure switch Model	: LPS
Pressure Range	: 50 to 120 bar 80 to 350 bar
Port connection	: 3/8" BSP (F)
Limit Switch	: Type LSPS with 1 NO , 1 NC

Pressure Control switch LPS, is employed to sense lubricant line pressure of Central Lubrication Pump outlet to stop the Pump incase of excess pressure OR at the ends line in dual line / Single line parallel system to signal the completion of cycle. Suitable Pressure Gauge is installed with the pressure control switch for its adjutment and to monitor the operation.

## MODEL IDENTIFICATION :

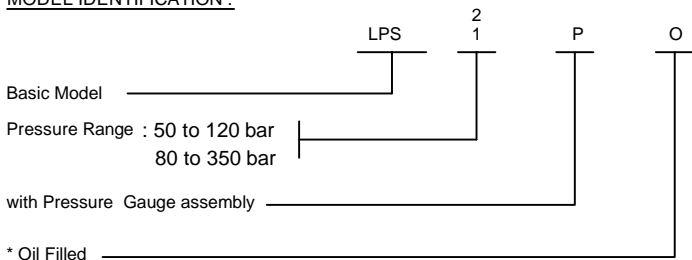

e.g. Pressure Control Switch of 80-350 bar range without Pressure gauge ,  
Oil filled type = LPS - 2 - O.

LUBCON ENGINEERS

Survey No. 23 , Hissa NO. 2 , Anand  
Vihar Colony , Hingane Khurd Off ,  
Sinhgad Road , pune 411 051.

**LUBCON**